

Vaneless Windmills

...OF THE...
10 ft. ALTHOUSE "RAYMOND" VANE-
LESS WINDMILLS.

January 1, 1901

No. of Part.	NAME OF PART.	10 foot Wheel.		12 foot Wheel.	
		No. pieces.	Weight for One Mill.	No. pieces.	Weight for One Mill.
1	Bed Plate.....	1	14 lbs.	1	14 lbs.
1a	Bolts.....	2	12	4	24
2	Step.....	1	7 1/2	1	7 1/2
2a	Bolts.....	2	12	2	12
3	Turntable.....	1	75	1	85
3a	Stop.....	1	10 1/4	1	10
3b	Bolt.....	1	02	1	02
3c	Roller Block.....	1	35	1	35
3d	Set Screws.....	2	06	2	06
3e	Rollers.....	1	30	2	30
4	Box Cap (large).....	1	40	1	40
4a	(small).....	1	30	1	30
7	Main Shaft.....	1	16	1	19
7a	Set Screw.....	1	06	1	08
7b	Washer.....	1	02	1	02
8	Spider.....	1	24	1	28
8a	Key.....	1	05	1	05
9	Crank Wheel.....	1	7 1/2	1	7 1/2
9a	Set Screw.....	1	05	1	05
10	Crank Pin.....	1	1	1	1
10a	Spring Pin.....	1	01	1	01
10b	Washer.....	1	01	1	01
11	Slide Head.....	1	3	1	3
11a	Rods.....	2	35	2	35
14	Front Slide.....	1	4	1	5
14a	Set Screws.....	2	06	2	06
14b	Bolts.....	6	12	6	18
17	Clutch Ring Top.....	1	1	1	1
18	Set Screws.....	2	06	2	06
19	Coupling Bolts.....	2	04	2	04
20	Bottom Oil Cup.....	1	30	1	30
21	Clutch Bar.....	1	50	1	50
22	Bolt.....	1	08	1	08
24	Weight Lever.....	1	04	1	04
25	Bolt.....	1	04	1	04
26	Washers.....	2	05	2	05
27	Weight.....	1	14 1/2	1	16 1/2
27a	Set Screw.....	1	08	1	08
28	Truss Posts.....	2	25	2	25
29	Bolt.....	1	05	1	05
30	Rod.....	1	30	1	30
33	Pitman.....	1	75	1	75
33a	Bolt.....	1	10	1	10
34	Upper Box.....	1	10	1	10
34a	Bolt.....	1	10	1	10
34b	Coupling Bolts.....	2	04	2	04
36	Swivel.....	1	1 50	1	1 50
37	Collar and Bar.....	1	75	1	75
38	Wood Rod Att.....	1	60	1	60
38a	Bolts.....	2	01	2	04
39	Section Levers.....	6	17	8	40
39a	Bolts.....	6	12	8	16
42	Arms.....	6	15	8	20
42a	Bolts.....	2	24	16	32
43	Trons.....	6 pr	8	8 pr	11
43a	Bolts.....	6	12	8	16
44	Section Center Bars.....	6	12	8	16
45	Inner Bars.....	6	8	8	11
46	Pans.....	84	40	104	6 24
47	Center Bar Castings.....	12	9	16	4 00
48	Inner.....	6	16	8	1 60
48a	Bolts.....	12	24	16	32
49	Rods.....	6	9	8	3 20
50	Complete (each).....	2	25	1	2 25
55	Splice Irons for Wood Rods.....	1 pr	2	1 pr	2
55a	Bolts.....	2	04	2	04
56	Wood Rods.....	2	10	2	10

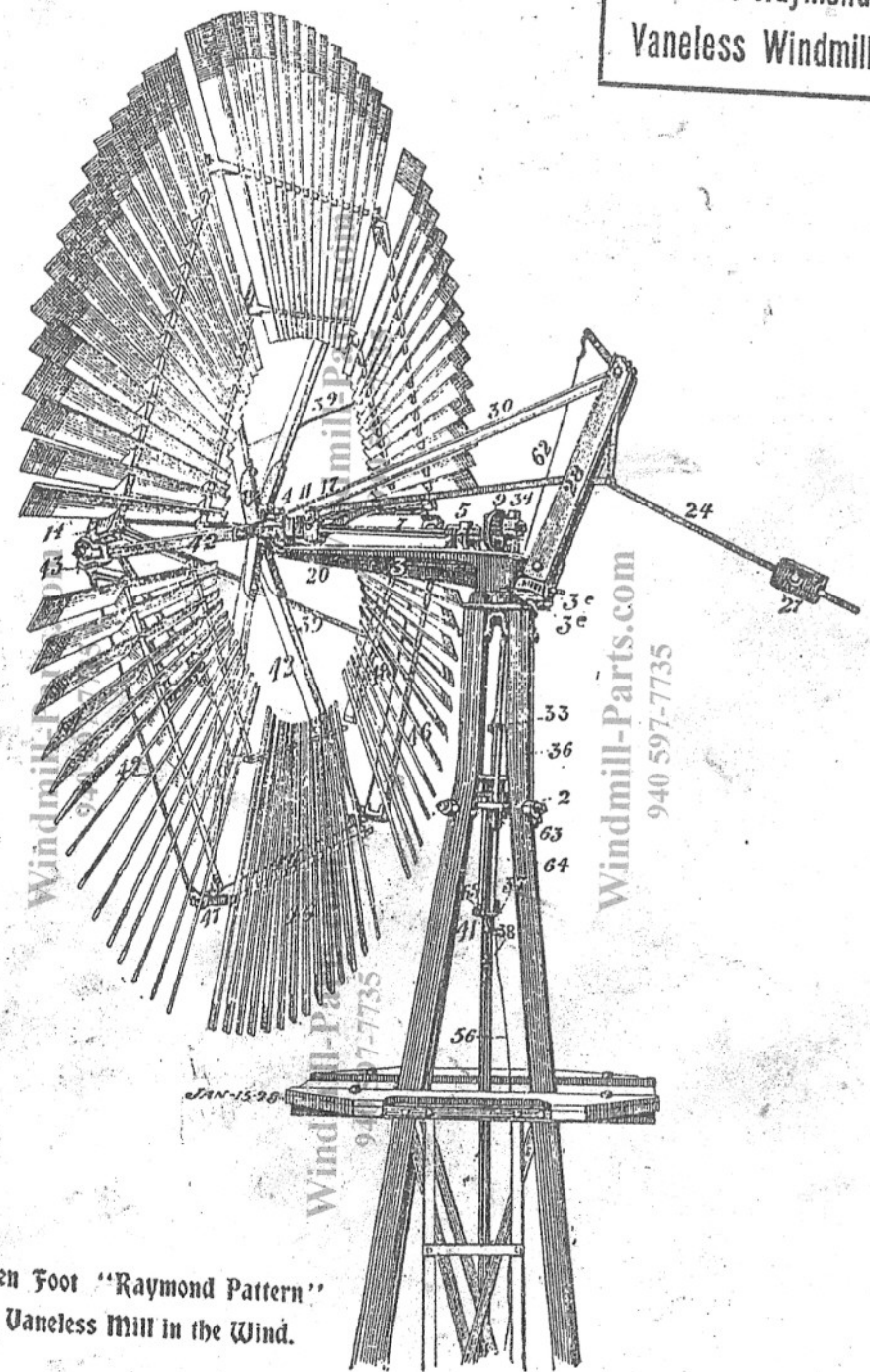

Ten Foot "Raymond Pattern"
Vaneless Mill in the Wind.

ALTHOUSE-RAYMOND
Vaneless Windmills

Windmill-Parts.com
940 597-7735

Windmill-Parts.com
940 597-7735

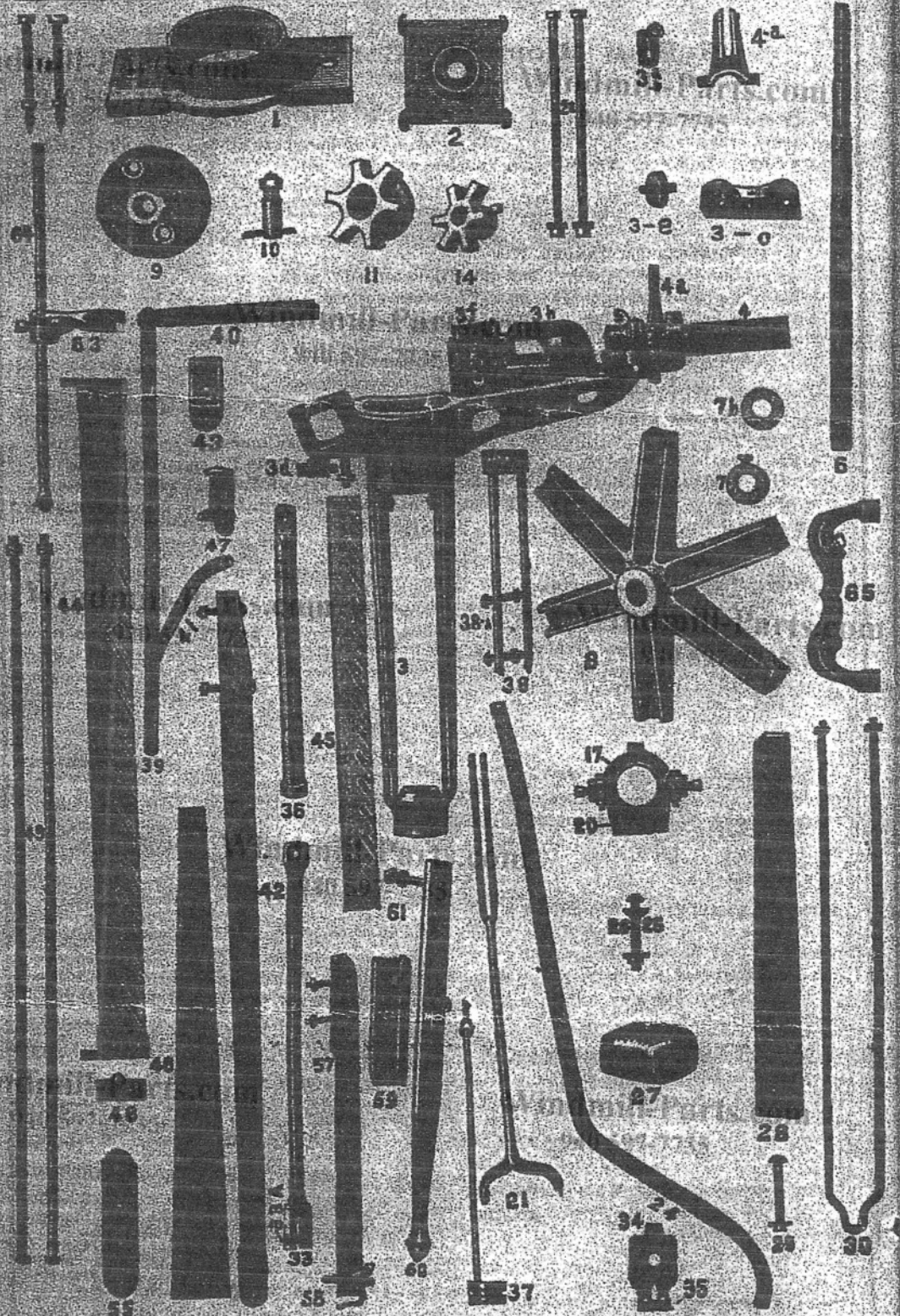

A Surveyor's chain is 66 feet long and contains 100 links.

An acre in the United States and England is 4,840 square yards; a Scotch acre 6,150; Irish, 7,560; Hamburg, 11,545; Amsterdam, 9,729; France, 11,960; Prussia, 2,059.

A NEW ATTACHMENT

For Throwing Mill "Out of the Wind."

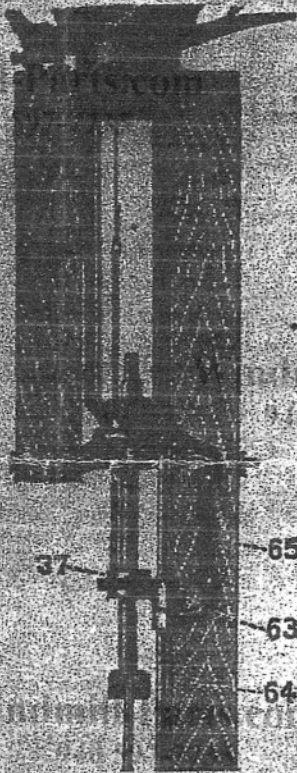

We have lately improved the device for pulling the mill "out of the wind," there having been some complaints about the wire cutting off where it passed through the grooved swivel. The cut opposite shows the new device. A grooved collar, No. 37, slides on the swivel, and a flat bar cast into this extends upward through the foot of turntable. A short wire connects the upper end of this bar to the weight lever. In future we shall make the slot in the foot of turntable, so that the wire can be attached to the flat bar before it is put through the foot of turntable, thus avoiding the difficulty which some inexperienced men have found in connecting this wire after the bar was put in place.

A clutch, No. 63, engages the grooved collar, No. 37, and this clutch is fastened on the rod, No. 64, which slides in the guide attached to one of the mast timbers. From the lower end of the rod No. 64, a wire extends to the hand lever near the ground.

Long Stroke Attachment.

We make an attachment for giving a longer stroke where mills are to be used over

TUBULAR WELLS.

The annexed cut shows the attachment so plainly that little explanation is needed. The casting "A" is bolted to one of the mast timbers and furnishes a fulcrum for the levers "D." The links, "C" and "E" make a connection from the swivel and wood rod attachments to these levers, and by varying the points of connection to the levers the stroke can be changed, giving any length of stroke, up to about nine inches.

The arrangement of double levers and links prevents any side draft, making the lift central, all the time.

This attachment can be placed on any of our 10 ft. or 12 ft. Pumping Mills by putting in a new swivel and wood rod attachment, and the parts shown in this cut between them. The price of this attachment is \$5.00.

