

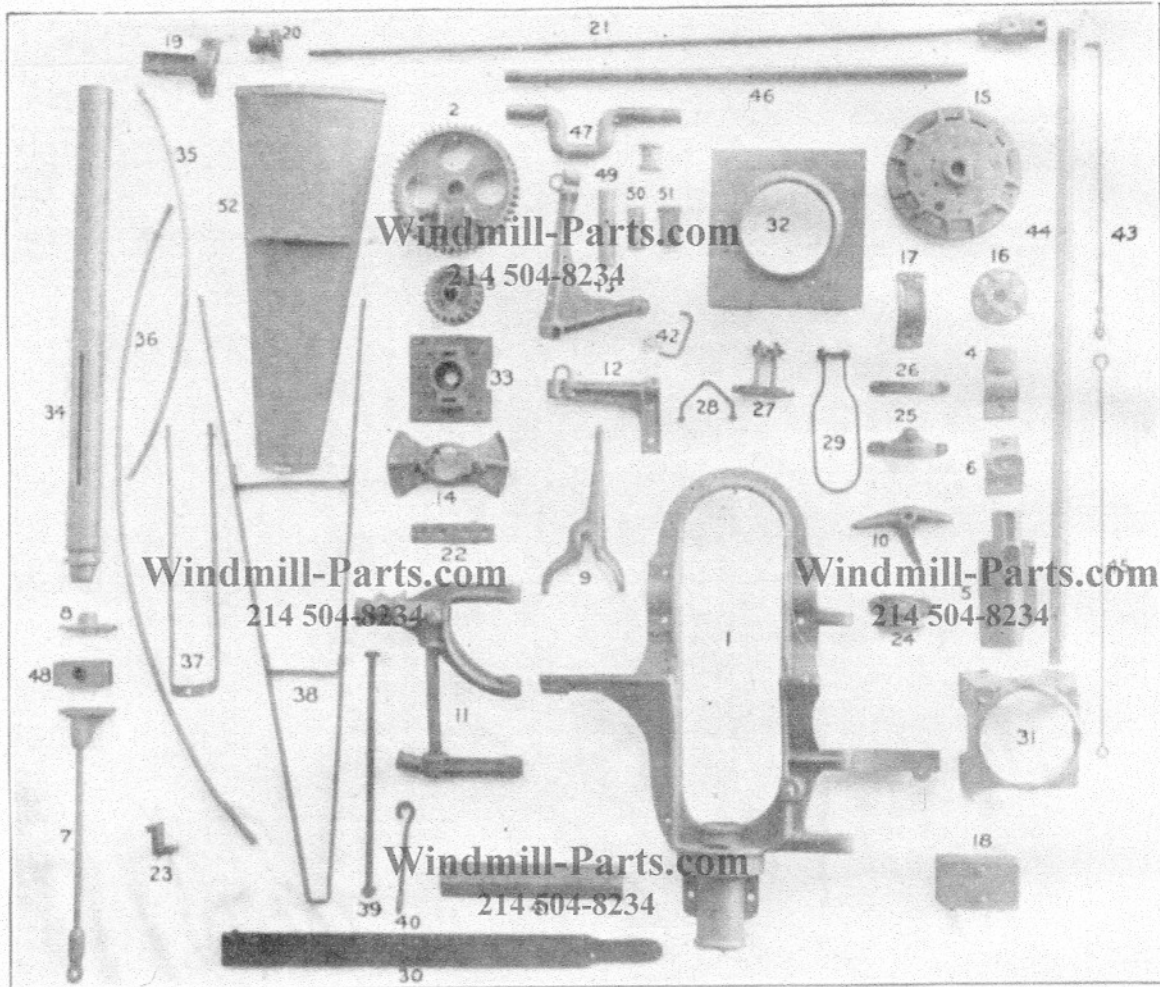

THE CHALLENGE LINE



Parts for 6, 8, 10 and 12-Foot Dandy Irrigator Mills
 Windmill-Parts.com 214 504-8234
 Windmill-Parts.com 214 504-8234



Name of Parts Shown Above

No.	Windmill-Parts.com	No.	Windmill-Parts.com
1	214 504-8234	19	214 504-8234
2		20	
3		21	
4		22	
5		23	
6		24	
7		25	
8		26	
9		27	
10		28	
11		29	
12		30	
13		31	
14		32	
15		33	
16		34	
17		35	
18		36	
19		37	
20		38	
21		39	
22		40	
23		41	
24		42	
25		43	
26		44	
27		45	
28		46	
29		47	
30		48	
31		49	
32		50	
33		51	
34		52	
35			



THE CHALLENGE LINE



Price List of Parts for 6, 8, 10 and 12-Foot Dandy Irrigator Mills

Windmill-Parts.com

Windmill-Parts.com

Ref. No.	Name of Part	6 FOOT		8 FOOT		12 FOOT			
		Casting No.	Price	Casting No.	Price	Casting No.	Price		
1	Main Casting	2166	\$10.65	2250	\$13.25	2110	\$13.75	2339	\$20.65
2	Gear	2167	4.50	2251	4.50	2111	5.00	1679	5.65
3	Pinion	380A	1.00	2257	2.00	1450	2.00	1680	3.75
4	Crank Box Cap	2168	.65	2252	.65	2112	.80	2301	1.00
5	Front Box Cap	2169	1.25	2253	1.25	2113	1.75	2302	2.00
6	Rear Box Cap	2170	.65	2254	.65	2114	.65	2303	1.00
7	Pitman	2171	.25	2263	1.75	2115	1.75	2306	3.25
8	Pitman Cap	2172	.35	2264	.35	2119	.65	2307	1.00
9	Brake Lever	2173	2.25	2258	2.00	2118	2.25	2308	2.25
10	Brake Trip	784	504-8234	2259	.65	138	.65	2309	1.25
11	Vane Hinge for Weight	781	3.25	2260	3.50	104	4.75	2310	5.65
	Vane Hinge for Spring	2739	3.25	2582	3.50	2597	5.00	2338	5.65
12	Weight Elbow	785	1.00	2262	1.00	113	1.25	2312	1.60
13	Pull-out Elbow	2173	2.00	2261	2.75	105	2.50	2311	2.80
14	Brake	783	1.25	103A	2.00	103A	2.00	130	3.50
15	Spider	782	2.50	102	3.50	102	3.50	133	4.25
16	Nose Piece	768	1.00	148	1.00	148	1.00	2581	2.80
17	Mast Clamp			996	.65	996	.65	2315	.80
18	Weight	790	2.00	2265	3.25	152	3.25	2313	5.00
	Spring Arm	2736	.45			2584	.80	2337	1.25
19	Swivel (Female)	993	.65	993	.65	993	.65	2316	1.25
20	Swivel (Male)	1547	.35	1547	.35	1547	.35	2317	.35
21	Plug	781	1.75	34	2.50	724	2.50	2318	2.80
22	Splice Iron		.35		.35		.35		.35
23	Step Hook	944	.35	944	.35	944	.35	2319	.50
24	Pull-out Sleeve	2271	.50	941	.50	941	.50	2320	.65
25	Pull-out Sleeve	2272	.45	942	.45	942	.45	2321	.65
26	Pull-out Sleeve	2273	.35	943	.40	943	.40	2322	.40
27	Pull-out Lever Bracket	1079	1.00	1079	1.00	1079	1.00	1169	1.00
28	Pull-out Lever Staple		.35		.35		.35		.35
29	Pull-out Lever Yoke		.40		.40		.40		.50
30	Pull-out Lever		.35		.35		.35		.35
	Pull-out Lever, complete		2.00		2.00		2.00		2.00
31	Steel Tower Chair	1025	3.50	1025	3.50	1025	3.50	2325	4.00
32	Wood Tower Chair	2722	4.25	2722	4.25	2722	4.25	2723	6.00
33	Step Plate	940	2.00	940	2.00	940	2.00	2323	4.50
34	Mast with Plug		4.00		4.00		4.00		6.30
35	Inside Rim		.35		.35		.65		.65
36	Outside Rim		214 504-8234		1.00		1.25		1.75
37	Pull-out Yoke		1.25		1.25		1.25		1.75
38	Wheel Arm		1.25		1.75		2.50		2.80
39	Vane Hinge Bolt		.40		.80		.80		1.25
40	Vane Hinge Link, long		.40		.40		.40		.40
40	Vane Hinge Link, short		.35		.35		.35		.35
41	Vane Brace Angle		.65		.65		.65		.80
42	Brake Link		.35		.35		.35		.35
43	Brake Rod		.35		.65		.65		.80
44	Weight Lever		.50		.65		1.25		
45	Pull-out Rod		.50		.50		.50		.50
46	Crank Shaft		3.50		4.00		4.00		4.50
47	Wood Shaft		3.75		4.00		4.00		8.25
48	Front Shaft Box, babbitt		214 504-8234		2.00		2.00		.40
49	Front Shaft Box, graphite		3.00		3.25		3.25		4.50
50	Rear Shaft Box, babbitt		.80		1.00		1.00		1.50
50	Rear Shaft Box, graphite		2.00		2.00		2.00		3.00
51	Crank Shaft Box, babbitt		.85		1.00		1.00		1.00
51	Crank Shaft Box, graphite		1.65		2.00		2.00		2.00
52	Wheel Slat		.80		1.10		1.10		2.85
	Slat Clips, per set		.40		.40		.45		.90
	Slat Brackets, per set		.65		1.25		1.25		2.50
	Wheel Sections, each		4.75		5.65		7.00		9.10
	Vane Sheet, complete		5.65		5.80		8.15		13.25
	Vane Cross Bar, long		1.00		1.00		1.00		1.25
	Vane Cross Bar, middle		.50		.65		.65		1.00
	Vane Cross Bar, short		214 504-8234		.35		.50		.65
	Vane Stem		3.75		4.50		4.75		6.25
	Vane Brace		.50		.80		1.00		1.25
	Vane Spring		1.25		1.65		2.00		2.00
	Bumper Springs		.35		.35		.35		.35