

1898 MODEL PUMPING AERMOTOR.

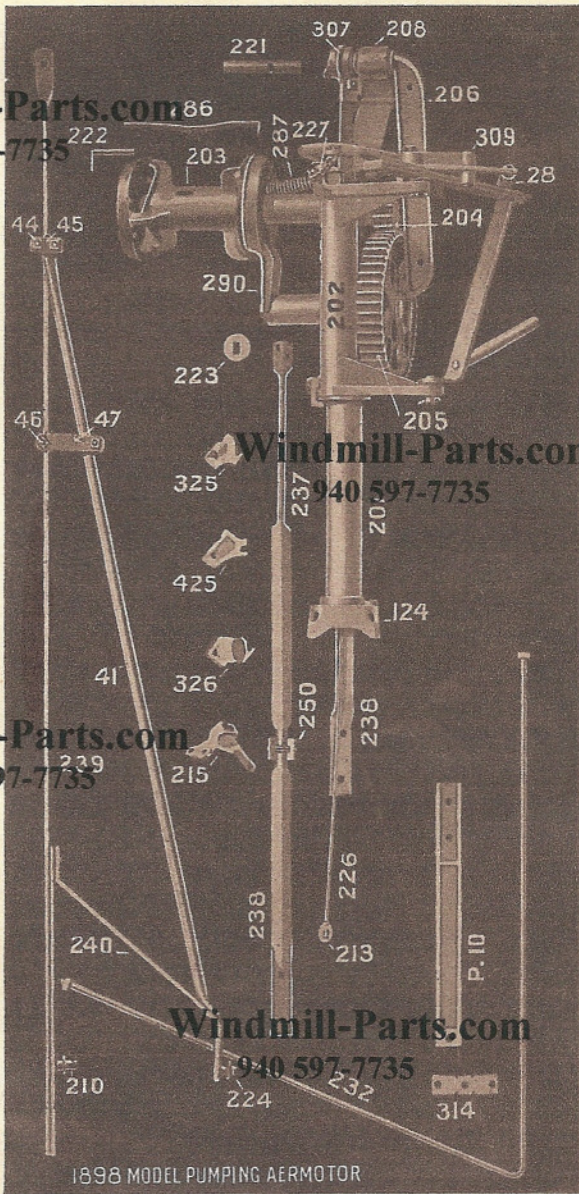

1898 MODEL PUMPING AERMOTOR

This illustration shows the parts of the Pumping Aermotor with roller bearings as made in the year 1898. Some of the parts used on the first mills of this model, and then discontinued, are not shown here. Among these are 207 threaded, replaced by 307 bolted; 209, replaced by 309; 225, threaded pump rod angle, replaced by 237, flatted and bolted. When either 207 or 225 are wanted for the old pieces should be ordered of the new pattern, 307 and 237, as the old parts are no longer furnished. The parts which are peculiar to this style of mill are numbered from 201 to 372.