

**DEMPSTER NO. 15 ANNU-OILED, TIMKEN ROLLER BEARING, DIRECT-STROKE WINDMILL PARTS**

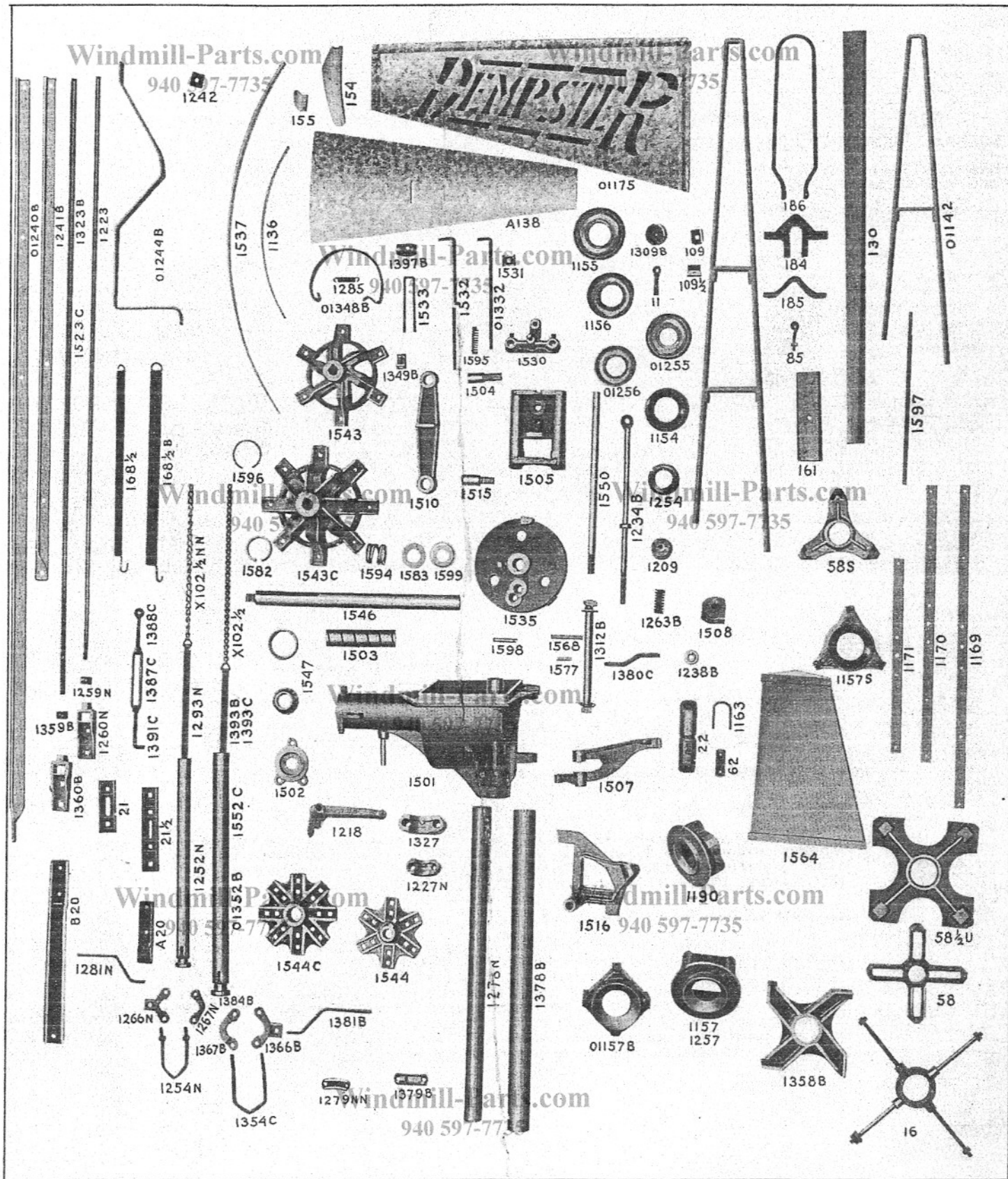

For 8-Ft. No. 15 Repair Parts, See Pages 21 and 22

For 10-Ft. No. 15 Repair Parts, See Pages 23 and 24

For 12-Ft. No. 15 Repair Parts, See Pages 25 and 26

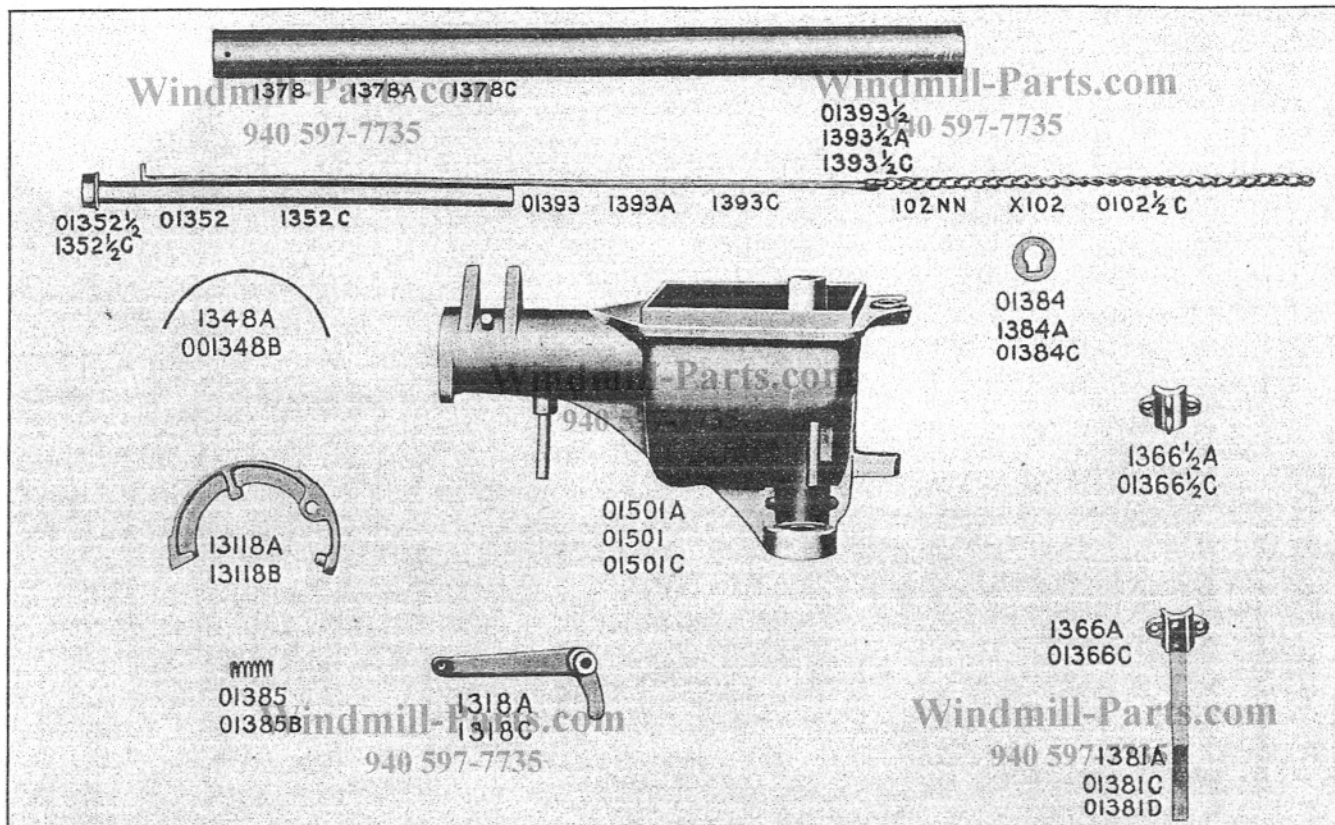

## NEW AND CHANGED PARTS FOR NO. 15 MILLS

Windmill-Parts.com

940 597-7735

**Instructions Covering Changes Made on No. 15 Mill**

In the latter part of 1931, improvements on No. 15 mills were as follows:

**FIRST—A New Brake.**

This brake pivots between two iron lugs cast integral on top of the shaft housing of the frame—consequently this frame is not interchangeable with the one using the previous style of brake, where the brake was carried on a lug casting on the side of the shaft housing. Neither is this brake interchangeable with the old style brake.

**SECOND—A New Pullout Tube.**

This tube is made of wrought steel pipe as compared to the previous pullout tube made of what is termed "bedstead" tubing. The bedstead pullout tube was slotted its full length and was of larger diameter than the present wrought steel tube. The flat chain strap on this pullout tube was riveted on the top end of the tube. The wrought steel pullout tube is not slotted and the chain strap extends the full length of the tube. To use the new style pullout tube in a mill equipped with the old style, a new pipe stem and pullout tube complete with swivels is required. In ordering pullout tube for any mill, it is essential that the type of tube be clearly specified in addition to what mill it is for.

Windmill-Parts.com

940 597-7735

## DEMPSTER 8-FT. NO. 15 ANNU-OILED WINDMILL

(EQUIPPED WITH TIMKEN ROLLER BEARINGS)

### REPAIR PRICE LIST

Part No.	List Price	PART NAME AND DESCRIPTION
11	940 597-7735	Eye Pump Pin
16N	1.40	Storm Stay--Wood Tower 1½"
A20	.50	Pump Connection
21	.50	Splice Irons for Actuating Rod, (per pair)
22	.86	Balance Weight for Wheel
057C	2.81	Bed Plate--Washer Bearing for 3" Angle Tower
58Q	1.67	Storm Stay--1½" Pipe--2" or 2½" Steel Tower
058C	2.81	Storm Stay--1½" Pipe--3" Steel Tower
58SS	.99	Storm Stay--1½" Pipe--3 Post Steel Tower
62	.06	Staple Bar for No. 22 Bal. Weight--1" x 3/16" x 3"
85	.12	Eyebolt for Wood Pullout Lever--5/16" x 3 3/8"--After Formed
102NN	.50	Pullout Chain 19" Long
109	.12	Outside Corner Washer--Steel Tower
109½	.12	Inside Corner Washer
130	.68	Wood Pullout Lever--3' 8" Long
154	.12	Fan Plate--Steel Wheel
155A	.04	Fan Ear
168½	1.40	Regulator Spring 5/8" I. D. x 21" No. 8
467	.56	Pullout Wire--40' No. 9 Galv. Wire
1136A	.36	Short Wheel Circle--1" x 1/8" x 20½", Punched for 4 Fans
1137A	.75	Long Wheel Circle--1 1/8" x 3/16" x 3' 5¼", Punched for 4 Fans
1138A	.81	Fan--4½" x 12½" x 30"
1142A	1.40	Wheel Arm--Spread at Top--1½"
-----		Spread at Bottom--6½"
-----		Short Side--32½"
-----		Long Side--35¼"
1157S	1.84	Bed Plate--3-Post Steel Tower (Use 1154 Collar Also)
1163	.25	Staple for Balance Weight--¼" Staple
1154	.44	Collar--Used with 1157S--For 1½" Stem
1169A	.50	Long Cross Bar for Vane--1" x 3/16" x 30"
1170A	.37	Medium Cross Bar for Vane--1" x 3/16" x 21"
1171A	.27	Short Cross Bar for Vane--1" x 3/16" x 12"
1175A	1.68	Vane Sheets for Vane--8" x 19" x 42"
1190A	2.11	Bed Plate--W. T.--1½" Stem
1208	.37	Sheave Guard
1209	.19	Sheave for Chain
1218	.50	Brake Lever
01223N	.99	Pump Rod--Complete with 01260N Swivel and 001259N Plug.
1227N	.37	Pipe Stem Clamp
1234	.68	Bumper Rod--½" x 5' 6"
1238	.08	Bumper Washer
01240	2.54	Vane Stem--1½" x 1½" x 1/8" x 7' 3"
1241	1.40	Vane Stem Brace--1¼" x 1¼" x 1/8" x 4' 9½"
01244A	.56	Vane Stem Strut
1242	.05	Bevel Washer
1249N	.19	Brake Band Clip
01252N	2.00	Pullout Tube Complete--(Consists of 1252N Tube, 1284N Guide, 1293N Flat Bar, Triangular Link, 102NN Chain)--1/0 Elwell 19" Long (Used on Mills 1931 & Prior)
		When Tube, Guide, or Flat Bar are needed, we suggest ordering Pullout Tube Complete
01254N	.19	Pullout Bail
1255	-----	Upper Ball Race--1½" Pipe--Obsolete--Use 01255 and 01256, Both Required
1256	-----	Lower Ball Race--1½" Pipe--Obsolete--Use 01256 and 01255, Both Required
01255	.69	Upper Ball Race--1½" Pipe
01256	.56	Lower Ball Race--1½" Pipe
1257	2.38	Bed Plate--Steel Tower and Wood Tower Combination
1259N	-----	Pump Rod Swivel Nut--Cast--Obsolete--Sub. 01259N
01259N	.19	Pump Rod Swivel Nut--Steel--Tapped ½"--12 Thd.--To Replace 1259N
1259½N	.19	Pump Rod Swivel Nut--Steel--Tapped ½"--Std.--Not Interchangeable with 1259N or 01259N
1260N	.50	Swivel
1263	.44	Bumper Spring--1" I. D. x 3 1/8" No. 3
1266N	.12	Pullout Swivel with Lug
1267N	.12	Pullout Swivel, Plain
1278N	2.97	Pipe Stem--1½" x 35"
1279NN	.19	Pipe Stem Clamp
1280	.19	Reg. Spring Arm--¼" x 1" x 6 1/8"
1281N	.19	Pullout Swivel Bar
1284N	.44	Pump Rod Guide
1285	.19	Spring--7/16" x 1 13/16" No. 12



**DEMPSTER 8-FT. NO. 15 ANNU-OILED WINDMILL****(EQUIPPED WITH TIMKEN ROLLER BEARINGS)—REPAIR PRICE LIST**

Part No.	List Price	PART NAME AND DESCRIPTION
1293N	\$0.26	Pullout Flat Bar
1309B	.19	Chain Sheave
1312	.56	Vane Hinge Pin-- $\frac{3}{4}$ " x $1\frac{1}{4}$ "
01332	.29	Brake Rod-- $\frac{3}{8}$ " x $13\frac{3}{4}$ "--Overall
1343	3.67	Wheel Spider--1 $\frac{1}{8}$ " Bore
1344	1.24	Brace Spider
1348	.94	Brake Band Only
1594	.37	Bearing Take-Up Spring--1 $\frac{1}{8}$ " I. D. x $1\frac{1}{4}$ " No. 6 L. H. Coil
1397	.19	Brake Band Bracket
1501A	-----	Main Frame (Disc. - See 01501A Below)
1502A	.69	End Plate for Outer Bearing
1503A	.62	Spacer Sleeve--1 $\frac{1}{8}$ " Bore
1504A	.44	Crosshead Pin--1" x $3\frac{11}{16}$ "
1505A	4.32	Crosshead
1507A	.69	Pullout Arm
1510A	.94	Pitman
1515A	.50	Wrist Pin-- 1 $\frac{1}{8}$ " x $3\frac{1}{8}$ "
1516A	1.19	Bumper Arm
1530A	.69	Guide Rod Spacer
1531	.05	Guide Washer for Brake Rod
1533	.22	Brake Rod Clevis
1535A	2.11	Face Plate--1 $\frac{1}{8}$ " Bore
1546A	1.73	Wheel Shaft-- 1 $\frac{1}{8}$ " x $19\frac{1}{4}$ ", with 1 Nut
1547A	3.89	Timken Bearing Complete-- 1 $\frac{1}{8}$ " (1985 Cone - 1930 Cup)
1550A	.56	Guide Rod-- $\frac{3}{4}$ " x 16"
1564A	4.00	Hood
1568A	.12	Key for Spider, $\frac{3}{8}$ "x $3\frac{1}{2}$ "
1577A	.12	Key for Face Plate, $\frac{3}{8}$ "x2"
1582A	.37	Spacer for Outer Bearing--2" Pipe-- $\frac{9}{16}$ " Wide, $\frac{1}{4}$ " Slot
1595	.31	Brake Rod Spring-- $\frac{7}{16}$ " I. D. x 3" No. 10
1596A	.15	Bearing Stop Ring-- $2\frac{1}{2}$ " O. D. x $\frac{3}{16}$ " Wide--1" Gap
1598A	.12	Pin for Chain Roller-- $\frac{1}{2}$ " x $2\frac{1}{4}$ "
1597A	.12	Brace for Guide Rod Spacer-- $\frac{3}{8}$ "x $14\frac{1}{4}$ " Long
1599A	.12	Oil Stripper Washer--1 $\frac{13}{16}$ " x $\frac{3}{16}$ " (1 $\frac{1}{8}$ " O. D.)
1985	2.52	Timken Cone--1 $\frac{1}{8}$ " I. D.
1930	1.58	Timken Cup
	.86	Steel Balls-- $\frac{5}{8}$ "--15 in a set (per set)
	5.78	Wheel Section

FOR PRICES ON COMPLETE BUNDLE OF ARMS OR CRATE SECTIONS  
SEE PRICES IN WINDMILL PRICE SHEET

**PARTS CHANGED ON NO. 15 MILL SINCE LATTER PART OF 1931  
AND EARLY PART OF 1932**

8-FT. NO. 15 MILL

Part No.	List Price	PART NAME AND DESCRIPTION
1218N	\$0.50	Brake Lever
01223N	1.67	Self Oiling Pump Rod, $\frac{1}{2}$ "x $5\frac{1}{4}$ " Complete with 01260N Swivel and 001259N Nut
001259N	.28	Pump Rod Swivel Nut
01260N	.86	Swivel with Nut and Set Screw (less pump rod)
01308	.22	Sheave Guard
1348A	.31	Brake Band, 1" x $\frac{1}{8}$ " x 8 $\frac{11}{16}$ "
01352	2.00	Pullout Tube Complete Includes: 01352 Pullout Tube, 01352 $\frac{1}{2}$ Tube Collar, 01393 Pullout Tube Flat Bar, 01393 $\frac{1}{2}$ Pullout Flat Strap and 102NN Pullout Chain 1/0 Elwell 19" Long. (Used on Mills 1932 & Later). If Tube, Collar, Flat Bar, or Strap is wanted, order Pullout Tube Complete
01352 $\frac{1}{2}$	-----	Pullout Tube Collar, 1 $\frac{11}{16}$ "x $\frac{1}{2}$ " (See Pullout Tube Complete)
01366A	.49	Pullout Swivel, Bar Side (Shipped only with 1381-A)
01366A	.37	Pullout Swivel, Wire Side
1378	2.97	Pipe Stem, $\frac{1}{2}$ "x $35$ " (Can be distinguished from 1278N by 01384 guide in bottom)
1381A	.49	Pullout Swivel Bar, $\frac{3}{4}$ " x $\frac{3}{16}$ " x 11" (Shipped with 01366-A)
01384A	.69	Pullout Tube Guide, 1 $\frac{9}{16}$ " O. D. x $\frac{7}{32}$ ", 2" Long
01385	.07	Brake Shoe Spring, $\frac{5}{8}$ " I. D. x 2", No. 12
01393	-----	Pullout Flat Bar, $\frac{5}{8}$ " x $\frac{3}{16}$ " x $35\frac{5}{8}$ " (See Pullout Tube Complete)
01393 $\frac{1}{2}$	-----	Pullout Flat Bar Strap, $\frac{5}{8}$ "x $1\frac{1}{16}$ "x2" (See Pullout Tube Complete)
13118A	1.13	Brake Shoe Complete
01501A	13.50	Main Frame (Interchangeable with 1501A, but must include 01385 Spring and 13118A Brake Shoe Complete, and 1218N Break Lever.)
1583A	.30	Felt Washer Retainer
1589A	.12	Felt Washer

## DEMPSTER 10-FT. NO. 15 ANNU-OILED WINDMILL

(EQUIPPED WITH TIMKEN ROLLER BEARINGS)

### REPAIR PRICE LIST

Part No.	List Price	PART NAME AND DESCRIPTION
11	\$0.12	Eye Pump Pin
16	2.11	Storm Stay--2" Pipe--Wood Tower
A20	940 597-7735	Pump Connection
21	.50	Splice Irons for Actuating Rods, (per pair)
22	.86	Balance Weight for Wheel
58BB	2.11	Storm Stay--For 2" Pipe--2" or 2 1/2" Steel Tower
58CC	2.97	Storm Stay--For 3" Tower
58S	1.03	Storm Stay--For 3-Post Tower
62	.06	Staple Bar for No. 22 Balance Weight--1" x 3/16" x 3"
85	.12	Eyebolt for Wood Pullout Lever--5/16" x 3 3/8"--after formed
X102	.50	Pullout Chain--21" Long--1/0 Elwell
109	.12	Outside Corner Washer--Steel Tower
109 1/2	.12	Inside Corner Washer
130	.68	Wood Pullout Lever--3' 8" Long
154	.12	Fan Plate--Steel Wheel
155	.04	Fan Ear--Steel Wheel
168 1/2 B	2.11	Regulator Spring--7/8" I. D. x 22"--No. 5
467	.56	Pullout Wire--40"--No. 9 Wire
1136	.44	Short Wheel Circle--3/16" x 1" x 3 3/4"--Punched for 4 Fans
01142	3.46	Wheel Arm--Spread at Top--1 1/2" Spread at Bottom--6 1/2" Short Side--44 3/8" Long Side--47"
1155	1.16	Upper Ball Race
1156	.79	Lower Ball Race
1157	2.21	Bed Plate--Wood or Steel (2 and 2 1/2")
1157A	3.67	Bed Plate--3" Angle Steel Tower
1157S	.84	Bed Plate--3-Post Steel Tower
1163	.25	Staple for Balance Weight--1 1/4" Staple
1169	.69	Long Cross Bar for Steel Vane--1/4" x 1" x 35"
1170	.56	Medium Cross Bar for Steel Vane--1/4" x 1" x 25"
1171	.40	Short Cross Bar for Steel Vane--1/4" x 1" x 15"
01175	2.05	Vane Sheet for Steel Vanes--9 1/2" x 20 1/2" x 54"
1190	2.11	Bed Plate--Wood Tower--for 2" Stem
1209	.19	Sheave for Chain
1218B	.50	Brake Lever
1234B	.95	Bumper Rod--5/8" x 2 1/4"--After Formed
1238B	.06	Bumper Washer
01240B	4.21	Vane Stem--2"x2"x1/8"x9'
1241B	2.11	Vane Stem Brace--1 1/4"x1 1/4"x1/8"x5' 7 7/8"
1242	.06	Bevel Washer
01244B	.94	Vane Stem Strut
1254N	.19	Pullout Bail
1263B	.44	Bumper Spring--1" I. D. x 3 1/8"--No. 3
1285	.19	Brake Spring--7/16" I. D. x 1 13/16"--No. 12
1293N	.26	Pullout Flat Bar
1309B	.19	Chain Sheave
1312B	.69	Vane Hinge Pin--7/8" x 12 1/2"
1323B	2.11	Pump Rod--5/8" x 5' 11"
1327B	.69	Pipe Stem Clamp
01348B	1.06	Brake Band
1349B	.12	Brake Band Clip
01352B	2.47	Pullout Tube, Complete (consists of 01352B Pullout Tube--1384B Pump Rod Guide--1393B Flat Bar--Triangular Link X102B Chain)--1/0 Elwell 21" Long. (Used on Mills 1931 & Prior) When Tube, Guide, or Flat Bar is needed, we suggest ordering Pullout Tube Complete
1359B	940 597-7735	Swivel Nut--5/8" Tap
1360B	.62	Swivel
1366B	.19	Pullout Swivel--with Lug
1367B	.19	Pullout Swivel--Plain Piece
1378B	3.19	Pipe Stem--2" x 3 5/8"
1379B	.31	Pipe Clamp Collar
1380C	.31	Regulating Spring Arm--3/8" x 1" x 6.3/8"
1381B	1.19	Pullout Swivel Stop Bar
1384B	.62	Pump Rod Guide
1387C	.94	Turnbuckle for Regulating Spring
1388C	.41	Regulating Spring Eyebolt--R. H. Thd.
1391C	.37	Reg. Spring Hook Bolt--L. H. Thd.
1397B	.19	Brake Band Bracket
1501	-----	Main Frame (Order 01501 Main Frame with 13118B and 01385B Assembled)
1502	1.19	End Plate for Outer Bearing
1503	.86	Spacer Sleeve--1 5/16" Bore
1504	.62	Crosshead Pin--1 1/8" x 3 3/4"
1505	4.21	Crosshead
1507	1.06	Pullout Arm
1508	.37	Sheave Guard

**DEMPSTER 10-FT. NO. 15 ANNU-OILED WINDMILL**(EQUIPPED WITH TIMKEN ROLLER BEARINGS)—REPAIR PRICE LIST  
(Continued)

Part No.	List Price	PART NAME AND DESCRIPTION
1510	\$1.73	Pitman
1515	.69	Wrist Pin, 1 1/4"x3 7/16"
1516	2.11	Bumper Arm
1530	.86	Guide Rod Spacer
1531	.06	Guide Washer Brake Clevis
1532	.44	Brake Rod
1533	.22	Brake Rod Clevis
1535	4.10	Face Plate--1 5/16" Bore
1537	1.30	Wheel Circle--3/16"x1 1/4"x54"--Punched for 4 Fans
1538	.75	Wheel Fan--5 1/2" x 13 1/2" x 30"
1543	-----	Wheel Spider--1 5/16" Bore--Obsolete--Sub. No. 01543
01543	4.91	Wheel Spider-- 1 5/16" Bore
1544	1.73	Brace Spider--1 5/16" Bore
1546	2.38	Wheel Shaft--1 5/16" x 2 1/2"x17/16"
1547	5.09	Timken Roller Bearing, Complete
1550	.69	Guide Rod--3/4" x 20 1/8"
1564	4.43	Hood
1568	.12	Key for Spider, 3/8"x3 1/4"
1577	.12	Key for Face Plate, 3/8"x2 1/4"
1582	.62	Spacer for Outer Bearing--2 1/4" x 9/16" Wide--1/4" Slot
1583	.37	Felt Washer Retainer
1589	.12	Felt Washer--1 1/4" J. D. x 2 1/2"--1/2" Thick
1594	.44	Bearing Take-Up Spring--1 3/8" I. D. x 1 5/8"--No. 3 L. H. Coil
1595	.15	Brake Rod Spring--7/16" I. D. x 3"--No. 10
1596	.37	Bearing Stop Ring--3 1/4" O. D. x 3/16" Wide
1597	.31	Brace for Guide Rod Spacer--7/16" x 18 3/4"
1598	.06	Pin for Chain Roller--1/2" x 2 3/8"
1599	.19	Oil Stripper Washer--1 5/16" I. D. x 2 5/16"--No. 8
2720	1.79	Timken Cup--1 5/16" I. D.
2785	3.35	Timken Cone
	1.62	Steel Balls--3/4"--15 in a set--(per set)
	7.13	Wheel Section

FOR PRICES ON COMPLETE BUNDLE OF ARMS OR CRATE SECTIONS  
SEE PRICES IN WINDMILL PRICE SHEET**PARTS CHANGED ON NO. 15 MILL SINCE LATTER PART OF 1931  
AND EARLY PART OF 1932**

10-FT. NO. 15 MILL

Part No.	List Price	PART NAME AND DESCRIPTION
1318A	\$0.44	Brake Lever
01323B	2.97	Self Oiling Pump Rod, 5/8"x5' 10 1/2" Complete with 01360B Swivel and 001259N Swivel Nut
01332B	.31	Brake Rod, 3/8" x 16" Over All
001348E	.44	Brake Band, 1 1/4" x 1/8" x 10 5/8"
001352A	2.15	Pullout Tube Complete Includes: 001352A Pullout Tube, Tube Collar, 01393A Flat Bar, X102 3934A Pullout Chain 1/0 Elwell 21" long. (Used on Mills 1932 & Later). If Tube, Collar, Flat Bar or Strap is wanted, order Pullout Tube Complete.
01352A	-----	Pullout Tube Collar (See Pullout Tube Complete)
01360B	1.13	Swivel with Nut and Set Screw (less pump rod)
01366A	.49	Pullout Swivel, Bar Side (Shipped only with 1381-A)
01366 1/2 A	.43	Pullout Swivel, Wire Side
1378A	2.95	Pipe Stem, 2"x3 3/4" (Can be distinguished from 1378B by 1384A guide in bottom)
1381A	.49	Pullout Swivel Bar, 3/4" x 3/16" x 11" (Shipped only with 01366-A)
1384A	-----	Pullout Tube Guide
01385B	-----	Brake Shoe Spring, 11/16" I. D. x 2 1/4", No. 10
1393A	-----	Pullout Flat Bar, 3/4"x3/16"x3 3/4" (See Pullout Tube Complete)
1393 1/2 A	-----	Pullout Flat Bar Strap, 3/4" x 1/16" x 2" (See Pullout Tube Complete)
13118E	1.52	Brake Shoe Complete
01501	23.76	Main Frame (Interchangeable with 1501 if furnished with 13118E and 01385B)
01504	1.00	Crosshead Pin - 1 1/8" x 4 1/8"
01515	.69	Wrist Pin, 1 1/4"x3 7/16" (Will not replace 1515)
01535	4.10	Face Plate, 1 5/16" Bore (Interchangeable with 1535 if furnished complete with 01515)
		Stud for 01535 (5/8"x4"--1 1/8" thread each end)
01543	4.91	Wheel Spider, 1 5/16"